



Model
CT 35
Cutter

CT 35 Model 35 Cutter

The Model CT35 Cutter is equipped with a heavy duty electric motor coupled to high velocity gearing for fast and efficient chopping, slicing, emulsifying and kneading.

- Chops all types of meat, pate, terrine, meatloaf etc.
- Slices all types of vegetables: onions, carrots, garlic, mushrooms, etc.
- Emulsifies all types of mayonnaise, puree, sauces, creams, etc.
- Kneads all types of pastry: pizza dough, pasta, cakes, etc.
- A security function switches the machine off if the bowl and safety cover are not in place.
- Polished stainless steel components are designed for easy cleaning.

SPECIFICATIONS

| | |
|------------------------------|--------|
| Blade: | 350mm |
| Blade RPM | 225 |
| 240V/50Hz single-phase motor | 0.40Hp |
| Net weight | 43kg |
| Bowl capacity | |

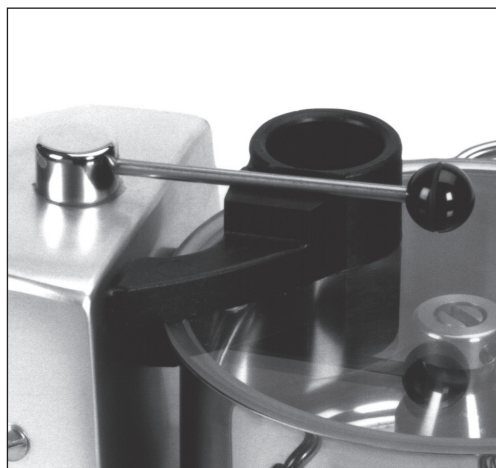
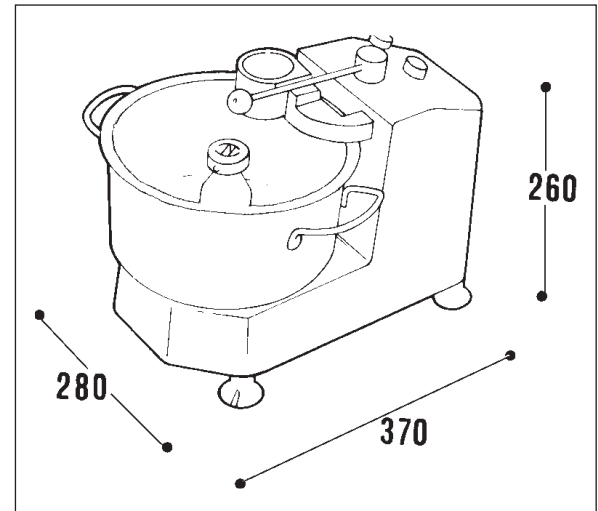

The Cutter will only operate when the safety lid and locking lever are in place.



Placing the ON/OFF switches low and to the side of the Cutter keeps hands safely away from accidents.

SALES AND SERVICE

SYDNEY: Ph: (02) 9838 0505; Fx: (02) 9838 0822
MELBOURNE: Ph: (03) 9888 7125; Fx: (03) 9888 7909
BRISBANE: Ph: (07) 3205 1077; Fx: (07) 3205 1144
ADELAIDE: Ph: (08) 8234 6277; Fx: (08) 8234 9033
PERTH: Ph: (08) 9204 3222; Fx: (08) 9204 3388
HOBART: Ph: (03) 6234 8300; Fx: (03) 6231 1291
DARWIN: Ph: (08) 8984 4125; Fx: (08) 8947 1900
WAGGA: Ph: (02) 6922 5836; Fx: (02) 6926 5657
FREECALL: 1800 353 844
EMAIL: info@briceaust.com.au

 Brice Australia Pty. Ltd.
 A.B.N. 71 413 589 669
 100% Australian owned and operated

Copyright © 2005 Brice Australia Pty. Ltd.
www.briceaust.com.au

Note: Specifications subject to change without prior notice