

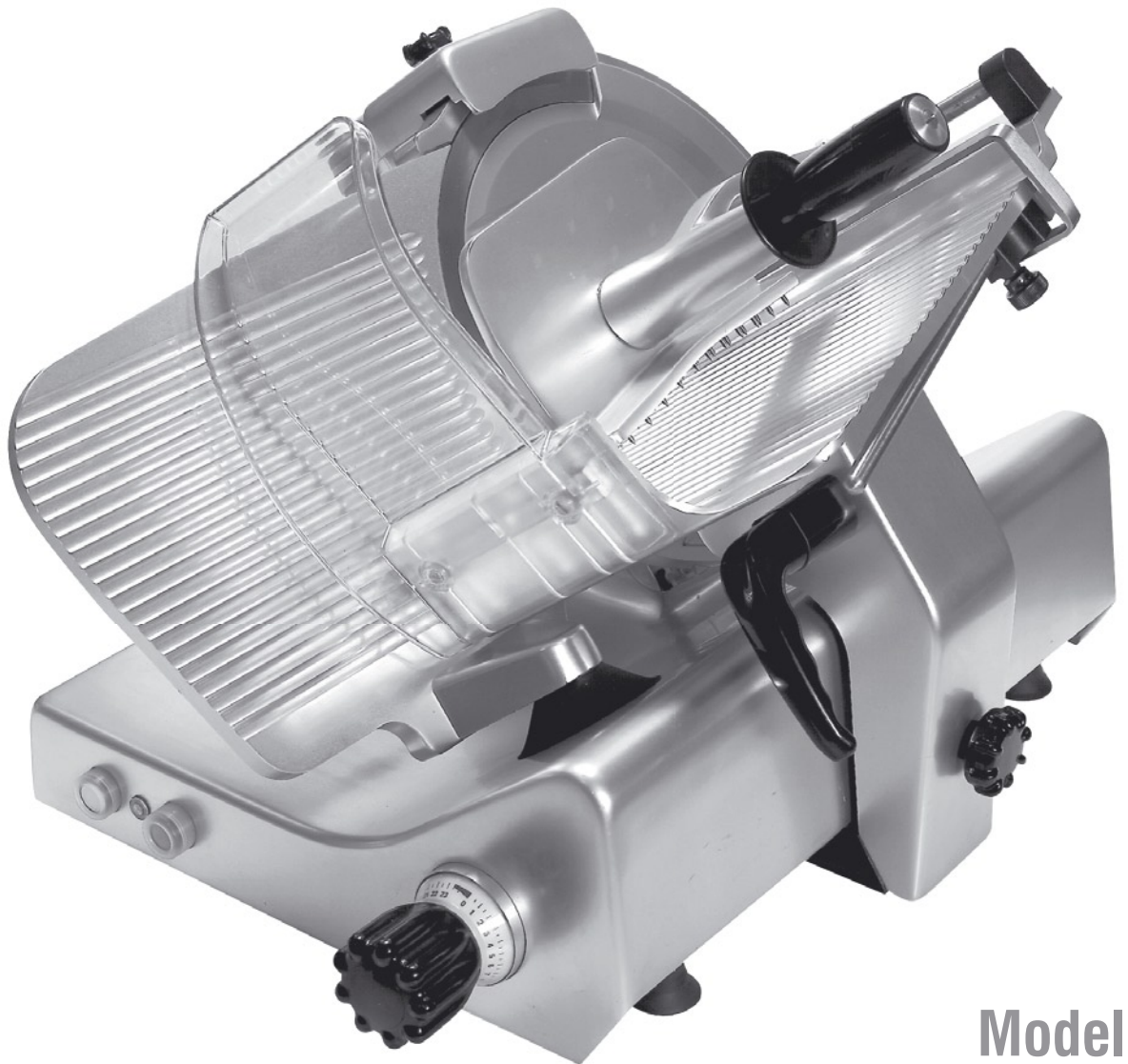

The 330IK manual slicer is a heavy duty powerhouse that takes the hard work out of slicing. An ideal slicer for caterers, medium/large kitchens and delicatessens.



Model
330IK
Gear Driven Slicer



Model 330IK Gear Driven Slicer

CE Approved

The Model 330IK gear-driven manual gravity feed slicer has been designed for heavy duty applications.

Anodised aluminium and stainless steel construction make the 330IK rugged. A large receiving plate, precision slicing action, and a full suite of safety features make the 330IK one of the most functional on the market.

- Manufactured in stainless steel and anodised aluminium to resist the corrosive effects of salts and acids;
- Conforms to all Australian and European standards. CE Approved.
- Micrometric thickness control allows for cutting of slices from 0 to 24mm;
- Self-contained and built-in sharpening device with grinding and finishing stones;
- All bearings are self-lubricating and sealed-for-life;
- Safety cutout switches for centre plate;
- Power switches are low-voltage for added safety;
- Fully-guarded blade and meat tray.



Micrometric adjustment for accurate slicing.



Fully guarded meat table and integrated sharpener keep operator safe.

SPECIFICATIONS

Overall Dimensions (mm)	745 x 592 x 498
Installation area (mm)	556 x 445
Working area (mm)	786 x 784 x 593
Blade (mm)	330
Motor	240V, 360W, 50Hz
Operating Temp. Range	Between 5°C and 40°C
Acoustic (dB)	Max. 70dB
Net Weight (kg)	51

Slice Capacity

Max. Slice Thickness (mm)	24
Cutting Capacity (dia., mm)	240
Cutting Capacity (rect., mm)	210 x 290

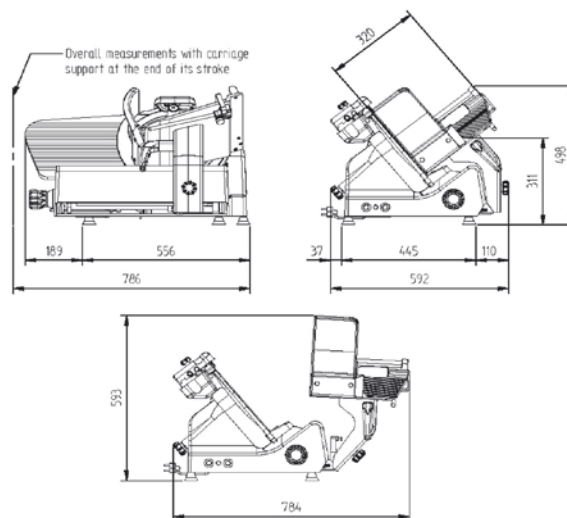

M Manual slicer (manual operation only)

G Gear-driven blade and/or carriage

H Rated for heavy duty/high volume environments

SALES AND SERVICE

SYDNEY: Ph: (02) 9838 0505; Fx: (02) 9838 0822

MELBOURNE: Ph: (03) 9888 7125; Fx: (03) 9888 7909

BRISBANE: Ph: (07) 3205 1077; Fx: (07) 3205 1144

ADELAIDE: Ph: (08) 8234 6277; Fx: (08) 8234 9033

PERTH: Ph: (08) 9204 3222; Fx: (08) 9204 3388

HOBART: Ph: (03) 6234 8300; Fx: (03) 6231 1291

DARWIN: Ph: (08) 8984 4125; Fx: (08) 8947 1900

WAGGA: Ph: (02) 6922 5836; Fx: (02) 6926 5657

FREECALL: 1800 353 844

EMAIL: info@briceaust.com.au



® Brice Australia Pty. Ltd.

A.B.N. 71 413 589 669

100% Australian owned and operated

Copyright © 2006 Brice Australia Pty. Ltd.

www.briceaust.com.au

Note: Specifications subject to change without prior notice