



The INT90 Tenderiser is a hard-working, heavy duty\* machine designed to produce “fillet” results from less valued cuts of meat.

- **Gear Drive**  
Powerful, heavy duty operation with fan-cooled\* motor for continuous service
- **Comprehensive electrical and mechanical safety features**
- **Stir-fry attachment**  
make perfect stir-fry strips every time
- **Easy cleaning**  
Machine disassembles quickly for effective cleaning
- **CE approved**



Model  
**INT90**  
Tenderiser



\* INT90 Fan Cooled only

# Model INT90 Tenderiser

The Model INT90 Tenderiser has been designed to produce "fillet" results from less valued meats.

Hundreds of small blades penetrate into the meat, cutting the muscle fibres, making it tender and succulent during the cooking process.

The INT90 is available in two configurations: Standard and Fan-cooled. The Fan-cooled option provides forced ventilation and cooling to the motor for heavy duty applications.

The unique Stir Fry cutting group slices meat into strips perfect for oriental cuisine.

- Manufactured in anodised aluminium to resist the corrosive effects of salts and acids;
- Blades stop when protective cover is raised;
- High mouth position and lower blade enclosure ensure operator safety;
- Reduces meat cooking times;
- Reversing switch;
- CE Approved.

## SPECIFICATIONS

No. of Blades (Standard cutting group)	2 x 44
No. of Blades (Stir Fry cutting group)	2 x 44
220/240V, 50Hz single phase motor	600W
220/380V, 50Hz three phase motor	650W
Net weight	(INT90) 22kg (INT90FC) 22.5kg

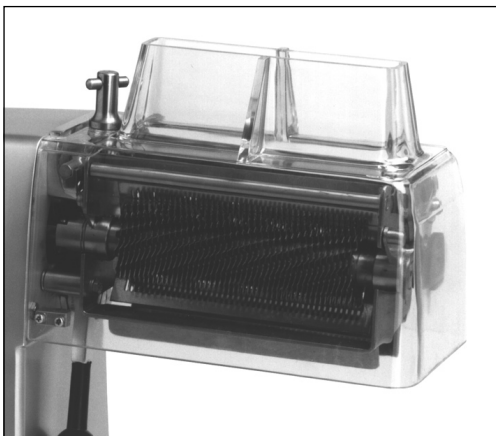
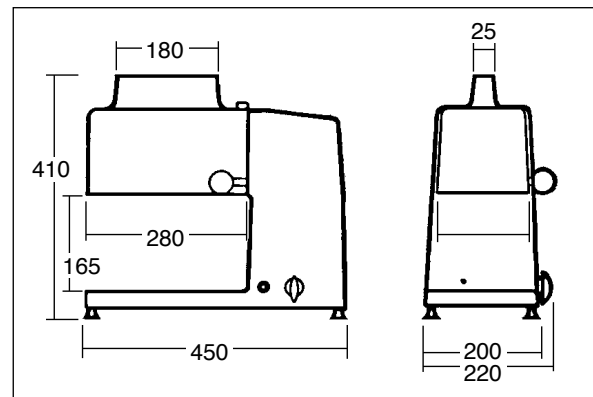

*The clear protective cover allows the operator to keep an eye on the meats being processed.*

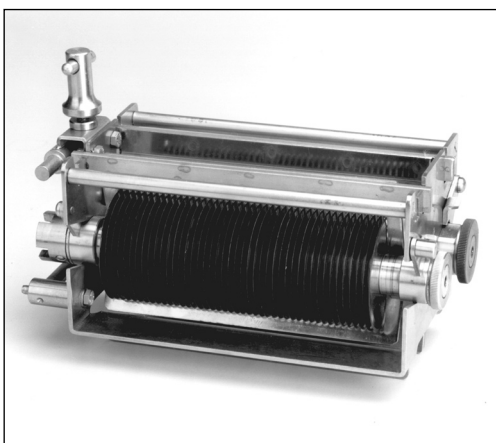

*The Stir Fry cutting group is perfect for oriental cuisine. Available in 4mm, 8mm or 12mm cutting configurations.*

## SALES AND SERVICE

<b>SYDNEY:</b>	Ph: (02) 9838 0505;	Fx: (02) 9838 0822
<b>MELBOURNE:</b>	Ph: (03) 9888 7125;	Fx: (03) 9888 7909
<b>BRISBANE:</b>	Ph: (07) 3205 1077;	Fx: (07) 3205 1144
<b>ADELAIDE:</b>	Ph: (08) 8234 6277;	Fx: (08) 8234 9033
<b>PERTH:</b>	Ph: (08) 9204 3222;	Fx: (08) 9204 3388
<b>HOBART:</b>	Ph: (03) 6234 8300;	Fx: (03) 6231 1291
<b>DARWIN:</b>	Ph: (08) 8984 4125;	Fx: (08) 8947 1900
<b>WAGGA:</b>	Ph: (02) 6922 5836;	Fx: (02) 6926 5657

**FREECALL: 1800 353 844**

**EMAIL:** info@briceaust.com.au



Brice Australia Pty. Ltd.  
ABN 71 413 589 669

100% Australian owned and operated

This document may not be reproduced, in whole or in part, by any means without the prior express written permission of the copyright owner. Brice and the BRICE logotype are trademarks of Brice Australia Pty. Ltd. Printed in Australia.

Copyright © 2006 Brice Australia Pty. Ltd.

[www.briceaust.com.au](http://www.briceaust.com.au)

Note: Specifications subject to change without prior notice

26169\_INT90\_br.pdf